

DOSE-O-MAT

SIZE: 2"

KB/KBA

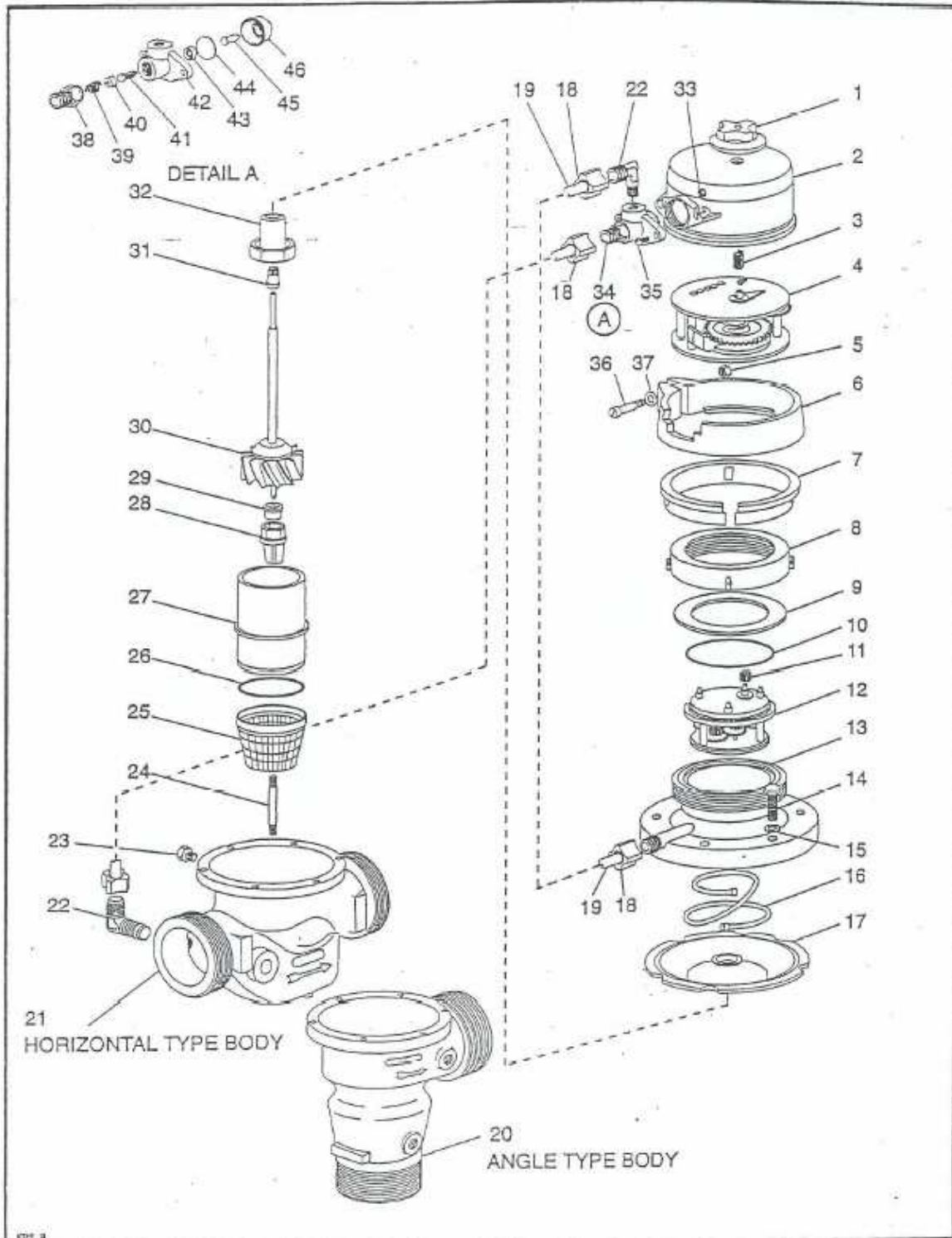

Dose-o-Mat KB/KBA 2"

Position	Cat. No	Description	Quantity
2	209-204-19	Control cover BD	1
3	274-209-09	Pilot valve spring K	1
4	529-262-09	Control mechanism KB 2" sc. 10	1
5	203-113-09	Pilot valve nut B	1
6	231-432-09	Belt ring B + KB	1
7	231-437-09	Holding ring KB + BW	1
8	258-202-09	Lock ring dialog (mach.)	1
9	231-400-09	Cover ring W	1
10	206-125-09	Buffer O-ring	1
11	221-110-09	Gear 50 0011 + natural assy	1
12	528-701-09	Transmission mechanism KB 2"	1
13	252-418-09	Body cover K 2"	1
14	210-116-09	Membrane cover screw KB 2"	6
15	230-201-09	Cover screw ring K	6
16	274-403-09	Membrane cover K 2"	1
17	206-233-09	Membrane K 2"	1
18	201-803-09	Nipple nut B	2
19	263-222-19	Pilot tube 22 (assy)	2
20	347-231-79	Body K 2 BS – angular	1
21	274-211-09	Spring Shastomit 06 green	1
21	347-196-79	Body K 2" (iron)	1
22	256-017-09	Angle nipple B	2
23	210-310-09	Plug 1/4" BSPT	1
25	212-807-09	Inlet spider screw K 2"	1
26	254-424-09	Strainer K 2"	1
27	206-139-09	Body O-Ring K 1-1/2"	1
28	250-404-09	Inlet spider K 2"	1
29	203-121-09	Inlet spider nut K 1-1/2"	1
30	285-315-09	Impeller bushing K + WM 2"	1
31	237-419-69	Impeller KB 2" (assy)	1
32	223-770-09	Gear 95 0009+	1
33	210-303-09	Membrane screw K 1-1/2-2"	1
34	203-113-09	Pilot Valve nut B	2
36	212-105-09	Pilot Valve screw B	2
37	214-715-09	Holding ring screw 1-1/2-2"	1
38	230-201-09	Cover screw ring K	1
39	256-301-09	Nipple nut B	3
43	245-250-09	Pilot valve body	1